

# 3 Wellington Place Leeds

MEPC

109,594 sq ft of Grade A office space &  
6,629 sq ft of retail/leisure space to let

Due for completion  
December 2017





# 3 Wellington Place – floor and space plans



Ground floor plan



Typical upper floor plan

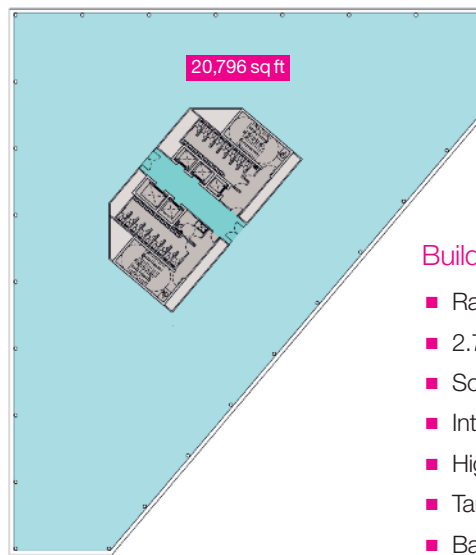

## Building specification

- Raised access floors with 150mm clear void
- 2.7m floor to ceiling height
- South face rooftop terrace
- Intelligent PIR lighting system
- High performance solar controlled glazing
- Target BREAM rating of excellent
- Basement parking

Typical upper floor - Example space plan

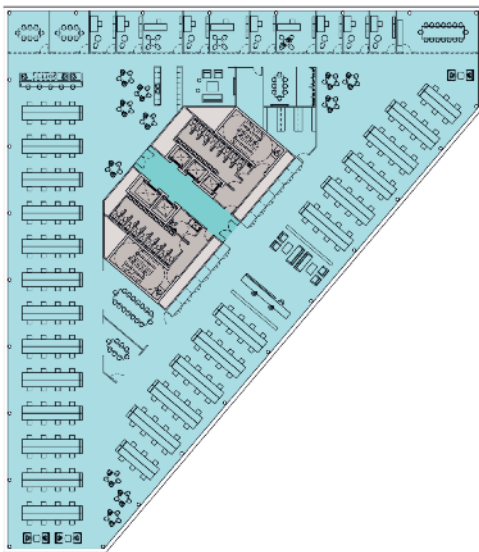

Fifth floor plan

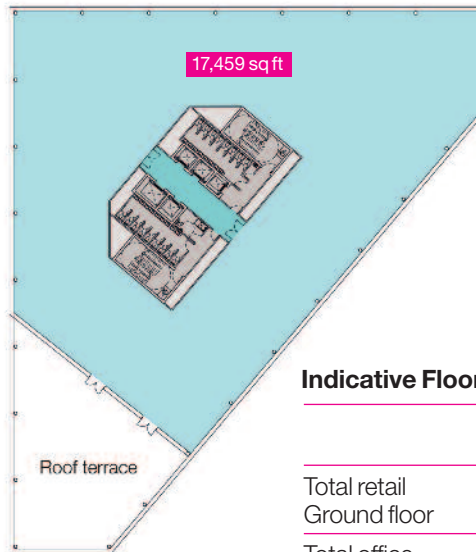

## Indicative Floor Sizes

	IPMS 3 sq m	GIA sq m	IPMS 3 sq ft	GIA sq ft
Total retail				
Ground floor		616		6,629
Total office				
Ground floor	968		10,425	
First floor	1,802		19,397	
Second floor	1,932		20,796	
Third floor	1,932		20,796	
Fourth floor	1,925		20,721	
Fifth floor	1,622		17,459	
<b>Total</b>	<b>10,182</b>	<b>616</b>	<b>109,594</b>	<b>6,629</b>

## Typical upper floor - Example space plan features

- 10 private offices
- dedicated reception area
- 6 meeting rooms
- server/comms room
- 6 soft seating areas
- kitchen/breakout area

Contact us now on **0113 389 9831** to find out about becoming a part of our growing business community

Wellington Place  
www.wellingtonplace.co.uk

MEPC Wellington Place  
Wellington Central  
Wellington Place  
Leeds LS1 4AP  
www.mepec.com

CUSHMAN & WAKEFIELD  
0113 233 7300  
cushmanwakefield.co.uk

JLL  
0113 244 6440  
jll.co.uk/property

### Misrepresentation Act 1967

At the time of printing the contents of this brochure were believed to be correct but cannot be guaranteed and are expressly excluded from any contract. October 2016.

Find us on Facebook  
 Follow us on Twitter: @wp\_leeds